

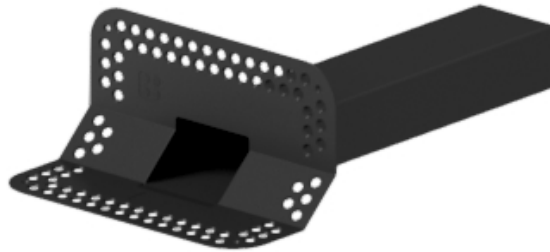

Data sheet

TPE Corner Outlet 45 degree (Perforated Flange) datasheet



Function:	TPE through wall or corner fittings made are used to connect bituminous waterproof roofing felt to rain water drains placed close to walls through bends for form a long term seal. They have a perforated flange with holes to help with heat bonding or sandwiching between layers of waterproofing membrane. The sides of the flange are angled to create a fillet to improve drainage. They are available in two versions either with a 65x100 mm rectangular section or with a 100x100 mm square section. Always prime outlet and membrane before installation.		
Compatibility:	They are compatible with APP and SBS prefabricated bituminous felts and liquid bituminous membranes.		
Range:	Section: (A x B) 65x100 100x100		
Performance:	Resistant to deterioration by the sun, ozone and other agents or chemicals normally found in the atmosphere. They have excellent flexibility even at low temperatures. The mechanical properties are maintained in the long term.		
Operating temperature:	-20°C; +70°C	Included accessories:	N/A
Material:	TPE	Optional accessories:	Bends, Angular gravel-excluders
Recycled product:	No	Recyclable:	Yes

Data Sheet

TPE Corner Outlet 45 degree (Perforated Flange) datasheet

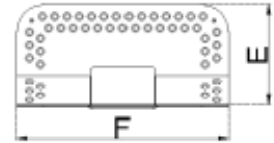
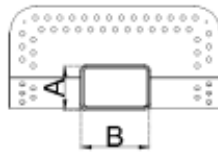
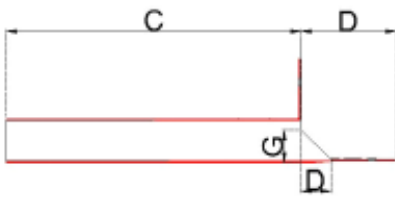

Item	Description	A	B	C	D	E	F	G	H
RO-TPE-030-321-065-100-Z	TPE Corner Outlet 45 degree perforated flange 65mmx100mm	65	100	427	140	150	310	44	46
RO-TPE-030-321-100-100-Z	TPE Corner Outlet 45 degree perforated flange 100mmx100mm	100	100	427	140	150	310	44	46

Additional Information:

For more information on interface with connectors etc. please refer to the corresponding Accessories datasheets.

